

ZONE Wall Protection



ZONE Wall Protection

Zone NZ Ltd are pleased to represent TEPROMARK in NZ and Australia.

Tepromark has supplied superior wall protection systems in North America since 1971. Since then a steadily expanding and improved product range has been introduced.

Accurately aware of the need for solid, dependable products that not only withstand impact, Tepromark has designed products that inspire and improve the look of the interiors they grace.

ZONE Wall Protection Benefits

- Controls maintenance costs
- Combines fashion with practicality
- Is long lasting and durable
- Reduces redecoration costs due to unsightly damage
- Provides a hygienic cleanable surface
- Minimises dust traps
- Provides a simple one stop shop solution to wall protection
- Is UL tested, covers meet US fire and smoke requirements
- Ex stock supply from our Auckland warehouse
- Provides a simple specification system to meet almost all requirements:
 - Handrail
 - Crashrail
 - Corner Protectors
 - Bed Bumpers
- Incorporates heavy duty full length extruded aluminum profiles, and clip on covers to speed installation, and reduce disruption
- Installation can be project managed completely by experienced Zone NZ staff.

ZONE Handrail /Crash Rail

For cost conscious institutions, the 960 Economy Series is an ideal choice. The 960 is textured over its entire surface, the inside and outside corners are molded from polypropylene. Handrails are UL approved and meet ADA standards. These handrails provide a 37mm knuckle space. The rails are made of 2mm thick, scratch and stain resistant rigid PVC, mounted on a 2mm thick full length extruded aluminum retainer.



Design Features

- Built as a handrail, it also serves as a great crash rail.
- Ergonomic design meets ADA regulations for comfort and safety.
- Protects against fungus and bacteria growth.
- Rails are provided in 3.65 meter lengths.
- Complete system includes molded returns and outside and inside corners.
- Installs easily.

Where Used

- Along hallways and in rooms that require a handrail suitable for pedestrian and wheelchair traffic.
- Counters in retail stores, hotels, hospitals, nursing homes, offices, etc
- Wherever wall protection is required to stop damage to walls from wheeled devices.

System Components

Profiled extruded aluminium retainers over which the PVC covers are mounted.

Vinyl covers include the hand grip section. Textured over entire surface.

End Caps - moulded from textured polypropylene.

Outside Corners - textured polypropylene.

Inside Corners - textured polypropylene.

Conical Spacer - Molded polypropylene stand off to accommodate ADA requirements.

How to Specify

Zone Wall Protection system T960 to be installed to walls as detailed.

T960 Handrail/crashrail is traditionally installed @ 900mm above floor height.

Colour - Eggshell

Handrail depth - 142 mm

Offset from wall - 37 mm

All components for T960 are supplied as a kit including:

- Aluminum extrusion
- Snap on cover
- End returns
- Wall offsets
- Fastners

For more information including approved fixing contractors please contact ZONE

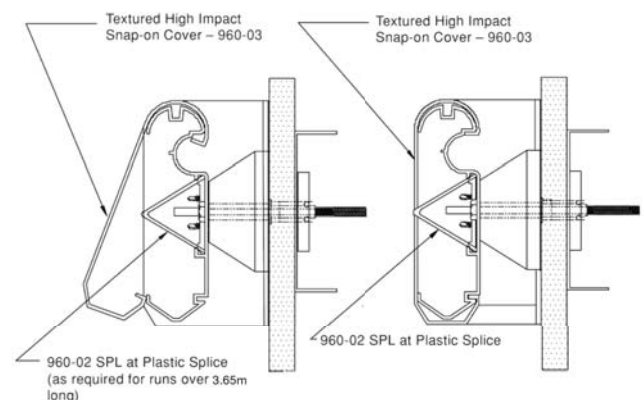

ZONE High Impact Corner Guard



Surface mounted, high-impact corner guards protect exposed and vulnerable corners from the roughest treatment. They are finished with 2mm thick vinyl covers that are mounted on 2mm thick, extruded aluminum retainers. Premium end caps are molded from 2.5mm thick ABS and are UL approved.



Design Features

- Offers protection from damage and wear at corners from carts, beds, wheelchairs or hand held items carelessly brushed against the corners.
- Available in the 100 Premium Series, with 50 x 50mm wings and 90° corners, 110 Premium Series with 75 x 75mm wings and 90° corners, 120 Premium Series with 75 x 75mm wings and 135° corners.
- Impact resisting PVC cover has an attractive textured finish that protects the corners from gouges, scratches and scuffs.
- Where required, American Disabilities Act (ADA) guidelines are met.
- Installs easily by snapping the vinyl cover over the aluminum retainer.
- For maximum impact resistance, the 100, 110 and 120 Premium Series, a firmly held PVC impact absorber can be inserted in the aluminum retainer. The absorber runs the entire length of the corner, increasing strength and preventing damage to the corner.
- Corner guards are provided in 1.825 meter lengths.
- Embossed bead on premium end caps allow for more appealing intersection of rail and end cap.

Where Used

Tepromark High Impact Corner Guards are installed on corners that would be damaged by moving objects that result in gouges, scratches and scuffs.

- Interior walls and partitions

- Door frames
- Rectangular columns
- Service counters

System Components

Extruded aluminium retainer - over which the PVC covers are mounted.

Impact Absorber

Vinyl Cover - textured.

End Cap - textured and profiled

How to Specify

Zone High Impact corner guards to be installed as detailed.

T100 - 50 x 50 mm - 90° outside corner

T110 - 75 x 75 mm - 90° outside corner

T120 - 75 x 75 mm - 135° outside corner

Colour - Eggshell

Height - 1825 mm

All components for T100,T110 and T120 are supplied as a kit including:

- Full length aluminum retainer
- Snap on PVC cover
- End caps
- Fasteners

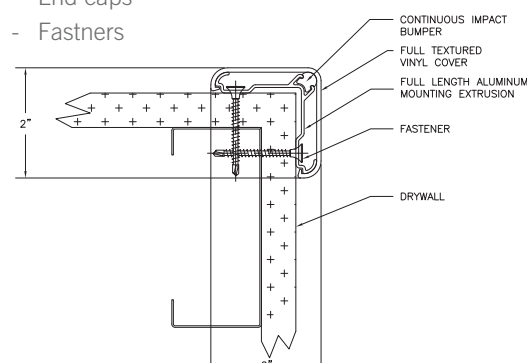

ZONE Wall Protection



Technical Data

MATERIALS

The rigid vinyl (PVC) and the flexible vinyl (PVC) used in manufacturing Tepromark International Inc products, are in compliance with the highest industry standards, (UL) and the American Disabilities Act (ADA). Parts have been carefully designed to take full advantage of production materials so that they are attractive, durable, impact resistant, hygienic, and pleasant to the touch.

Extruded aluminum retainers impart structural strength. They are manufactured from an aluminum alloy specifically formulated to be used for this purpose.

End stops, corners, corner adapters and end caps are molded from an ABS or polypropylene compound to provide durability and impact resistance. Impact resistance is increased by molding all pieces in 2.5mm thick cross sections and by designing a series of internal webbing.

TEPROMARK PVC material meets the UL standard 94VO. Tepromark products have been tested for surface burning characteristics by Underwriters Laboratories, Inc. The standard UL 723, "Tests for Surface Burning Characteristics of Building Materials," is used by Underwriters Laboratories Inc. to investigate specific building materials and develop Flame Spread and Smoke ratings. This test standard is widely recognized and specified in the major building codes of the United States and Canada. It is approved by the American National Standard Institute as Standard (A2.5), the American Society for Testing and Materials (ASTM E-84) and the National Fire Protection Association (NFPA 255). In addition, the vinyl material used to manufacture TEPROMARK products has a CCI classification, as tested in accordance with the procedures specified in ASTM O-625, Standard Test Method for Rate and Burning and/or Extent and Time of Burning of Self-Supporting Plastics in a horizontal position, as referenced in UBO 52-4-1988.

Note: Class A is the designation of the National Fire Protect Association. Class 1 is the equivalent, but not used by UL. Both of these ratings are the same as UL.

PVC PROPERTIES

Tensile Yield of the rigid vinyl is 6100 psi and of the ABS of 5400 psi, as tested in accordance with the procedures specified in ASTM D638.

Chemical and Stain Resistance provided in the rigid vinyl and ABS shows resistance to stain when tested in accordance with applicable provisions of ASTM D-543.

Fungal and Bacterial Resistance provided in the rigid vinyl indicates the material does not support fungal or bacterial growth tested in accordance with ASTM G-21 and ASTM G-22.

Colour Consistency provides thermoplastic components matched in accordance with SAE J-1545-(Delta E) with a color difference no greater than 1.0 units using CIE Lab, CIE CMC, CIE Lch, Hunter Lab or similar color space scale systems.

Abrasion Resistance The PVC material used in TEPROMARK'S extrusions are highly resistant to abrasion.

Aluminum Retainers are extruded from 6063-T5 alloy. This aluminum alloy has a tensile strength of 29,000 psi, a yield strength of 25,000 psi, an elongation (% on 50.8mm) of 12 and a Brinell Hardness of 73.

Maintenance

Little maintenance is required when TEPROMARK vinyl covers, vinyl and clear corner protectors, vinyl corner guards and molded end stops are properly installed. See prior paragraph on installation. Lightly soiled materials can be cleaned with a mild rubbing action using detergent mixed into warm water. With normal using detergent mixed into warm water. With normal use, Tepromark products should remain damage free for many years. If a part is damaged due to harsh treatment, arrangements can be made with Tepromark to replace without replacing the entire system.

COLOUR RANGE

PVC color samples with textured finish will be supplied on request.

SPECIFICATIONS

The diameter or width of the gripping surfaces of the handrail shall be 31.75mm to 38mm or the shape shall provide an equivalent gripping surface. Hand rails provide an equivalent gripping surface. Hand rails mounted adjacent to the wall shall have adequate knuckle space. The space between the wall and hand rail shall be a minimum of 38mm.

TEPROMARK products meet the applicable guidelines called for in the American Disability Act (ADA).



ACCESSIBILITY GUIDELINES